

# unimec 1D/1E/1F

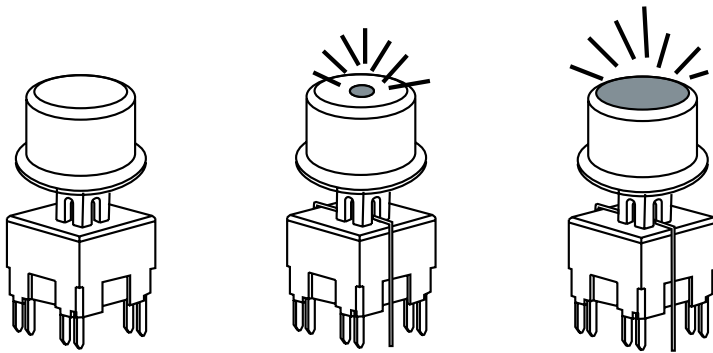

## Technical Data:

- Max. 250mA/120V/9W AC/6W DC
- 2 pole
- momentary or alternate
- 8 contact functions
- temperature range:  
low temp: -40/+75°C  
high temp: -40/+160°C
- through-hole only

## Dimensions (through-hole)

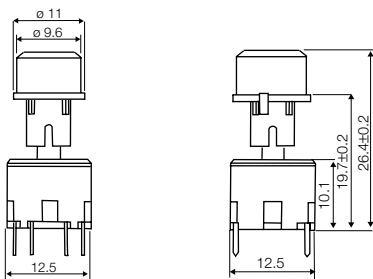

## PCB layout

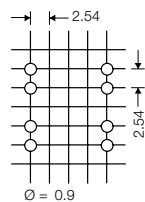
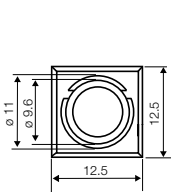

## Dimensions (w/LED)

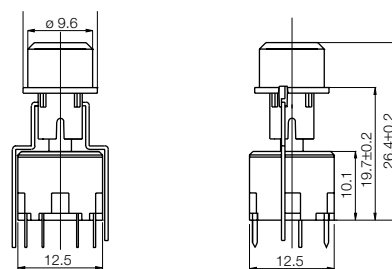

## PCB layout (solder side)

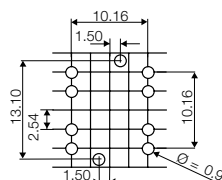
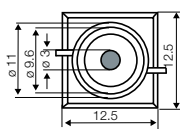

## Dimensions (w/LED)

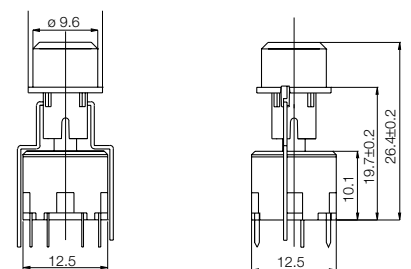

## PCB layout (solder side)

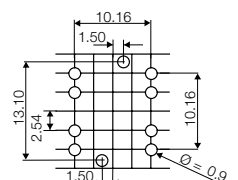
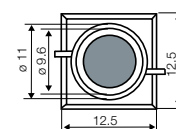

## HOW TO ORDER

1 5 + 1 6 2 5 0 + 1 D

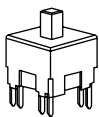

### Switch

- 15501** mom. silver
- 15551** alt. silver
- 15502** mom. gold
- 15552** alt. gold
- 15500** silent silver
- 15401** mom. silver  
high temp.
- 15451** alt. silver  
high temp.



### Extender



### Cap

- 00** blue
- 02** green
- 03** grey
- 04** yellow
- 06** white
- 08** red
- 09** black

1 5 + 1 6 2 5 0 + + 1 6 9 2 3

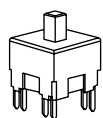

### 1E

### Lens

- 1** transparent
- 2** green
- 4** yellow
- 8** red

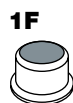

### 1F



### LED

- 00** blue
- 20** green
- 40** yellow
- 80** red
- 2040** green/yellow
- 8020** red/green
- 8040** red/yellow

Ordering example: 15501 + 16250 + 1E098 + 1692380