

multimec® 3F + 1D/1E/1F

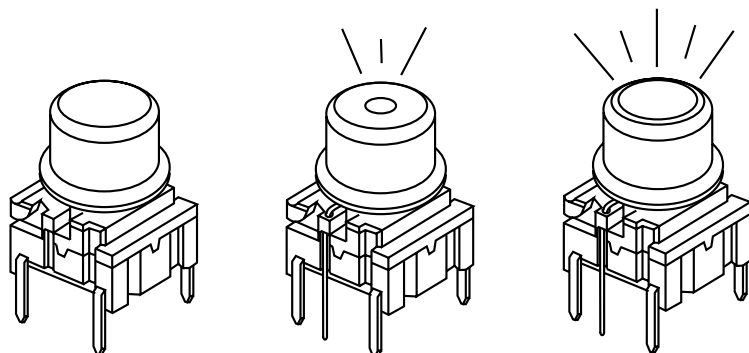

Technical Data:

- through-hole or SMD
- 50mA/24VDC
- single pole/momentary
- 10.000.000 operations life time
- IP67 sealing
- temperature range:
low temp: -40/+115°C
high temp: -40/+160°C

Dimensions (through-hole)

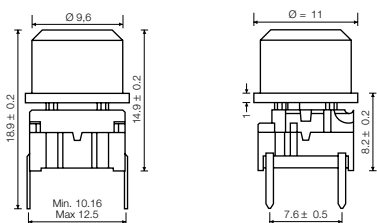

PCB layout

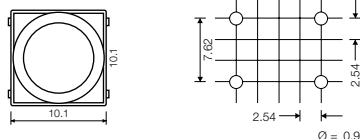

Dimensions (w/LED)

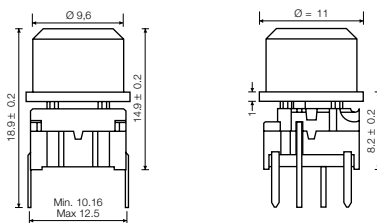

PCB layout (solder side)

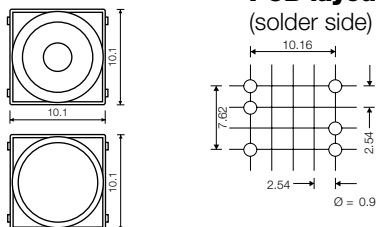

Dimensions (SMD)

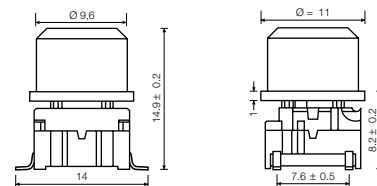

PCB layout

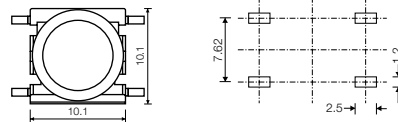

HOW TO ORDER

3 F

Switch



Mounting

T through-hole
S surface mount



L 6 low temp.
H 9 high temp.

+

1 D

Cap



00 blue
02 green
03 grey
04 yellow
06 white
08 red
09 black

Standard versions:

3FTL6
3FTH9
3FSH9

3 F

Switch



Mounting

T through-hole



L 6 low temp.
H 9 high temp.

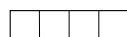

LED

00 blue
20 green
40 yellow
80 red
2040 green/yellow
8020 red/green
8040 red/yellow

+



Cap 1E



Cap 1F



00 blue
02 green
03 grey
04 yellow
06 white
08 red
09 black



Lens

1 transparent
2 green
4 yellow
8 red

Standard versions:

3FTL600
3FTL620
3FTL640
3FTL680
3FTL62040
3FTL68020
3FTL68040

Ordering example: 3FTL620 + 1E032