

# multimec® RAS + 1D/1K/1P/1S

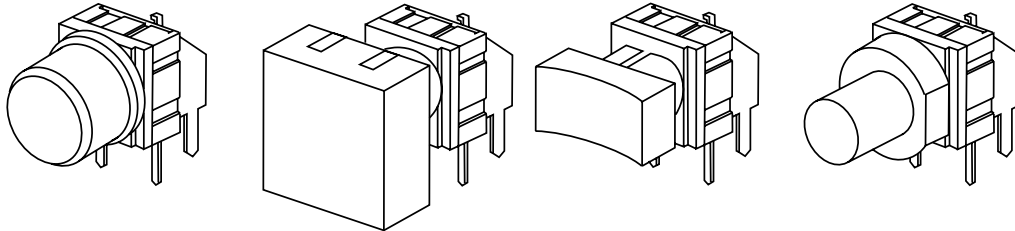

### Technical Data:

- through-hole only
- 50mA/24VDC
- single pole/momentary
- 10.000.000 operations life time
- IP67 sealing
- temperature range:  
low temp: -40/+115°C

### Dimensions 1D

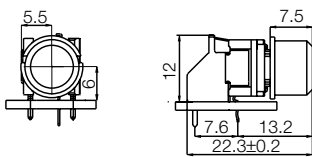

### PCB layout

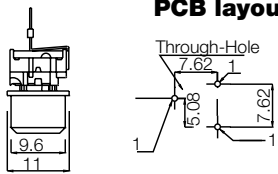

### Dimensions 1K

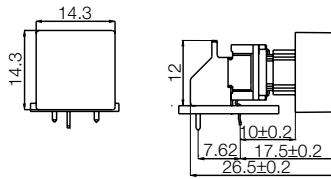

### PCB layout

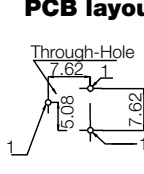

### Dimensions 1P

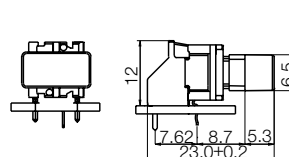

### PCB layout

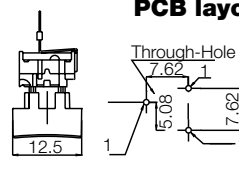

### Dimensions 1S

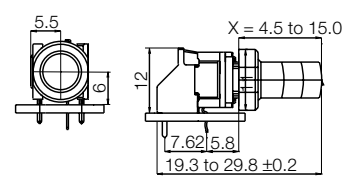

### PCB layout

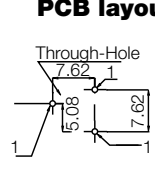

### HOW TO ORDER

<b>3 F</b>	<b>T</b>	<b>L 6</b>	<b>R A S</b> +		<b>Cap 1D</b>	<b>00</b> blue	
<b>Switch</b>	<b>Mounting</b>	<b>L 6</b> low temp.	<b>Right angle support</b>		<b>02</b> green		
	<b>T</b> through-hole				<b>03</b> grey		
					<b>04</b> yellow		
					<b>06</b> white		
					<b>08</b> red		
					<b>09</b> black		
					<b>Cap 1P</b>	<b>00</b> blue	
					<b>03</b> grey		
					<b>08</b> red		
					<b>09</b> black		
				<b>1 K</b> <b>1 6</b> +	<b>Cap 1K</b>	<b>00</b> blue	<b>2 K</b>
					<b>02</b> green		<b>Bezel</b>
					<b>03</b> grey		<b>03</b> grey
					<b>04</b> yellow		<b>06</b> white
					<b>06</b> white		<b>08</b> red
					<b>08</b> red		<b>09</b> black
					<b>09</b> black		
				<b>1 S 0 9</b> - .	<b>Cap 1S09 black</b>	<b>H</b>	<b>X *</b>
						16.0	8.5
						19.0	11.5
						22.5	15.0

\*Any cap height X from 4.5 to 15.0 mm is available. Please order 1S09-H, where H = X+7.5 mm  
Min. order Qty for custom heights is 2.000 pcs. A start-up charge will apply.

**Ordering example:** 3FTL6RAS + 1K0016 + 2K03