

TYPICAL INDICATOR ORDERING EXAMPLE

KB **02** **K** **W01** — **12** — **FF**

SHAPES	
Bushing Mounting	
01	Square
02	Round
03	Rectangular
Snap-in Mounting	
04	Square
05	Round
06	Rectangular

HOUSING	
K	Black only

TERMINALS	
W01	Silver Solder Lug

LAMPS	
Incandescent Lamp used w/Solid Cap	
05	5-volt
12	12-volt
28	28-volt

Incandescent or Neon Lamp used with Insert Cap	
05	5-volt
12	12-volt
28	28-volt
01	110-volt Neon

Standard LED used with Cap for LED	
C	Red
D	Amber
F	Green

Bright LED used with Cap for LED	
5C	Red
5D	Amber
5F	Green

Super Bright LED used w/Cap for LED	
6B	White
6F	Green
6G	Blue

CAP TYPES & COLOR COMBINATIONS			
Solid Cap: Lens/Filter Colors			
BB	White/White	FB	Green/White
CB	Red/White	FF	Green/Green
CC	Red/Red	GB	Blue/White
EB	Yellow/White	GG	Blue/Blue

Insert Cap: Lens/Filter Colors	
JB	Clear/White
JC	Clear/Red
JE	Clear/Yellow
JF*	Clear/Green
JG*	Clear/Blue

* JF & JG not suitable with neon.

LED Cap: Lens/Diffuser Colors	
AB	Black Cap/White Window for Spot Illuminated (Square only)
JB	Clear/White
JC	Clear/Red
JD	Clear/Amber
JF	Clear/Green

LED Cap: Lens/Diffuser Colors	
AB	Black Cap/White Window for Spot Illuminated (Square only)
JB	Clear/White
JC	Clear/Red
JD	Clear/Amber
JF	Clear/Green

LED Cap: Lens/Diffuser Colors	
JB	Clear/White

DESCRIPTION FOR TYPICAL ORDERING

EXAMPLE

KB02KW01-12-FF

12-volt
Incandescent Lamp
Solid Cap with
Green Lens and
Green Filter



Black Housing
Round Shape and Bushing Mounting

Silver Solder Lug Terminals

SHAPES & MOUNTING TYPES

Bushing Mounting

01 .551" Square

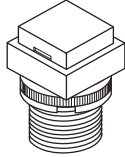

02 .551" Round

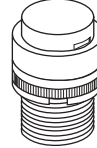

03 .551" x .728" Rectangular

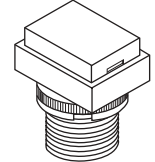

Snap-in Mounting

04 .551" Square

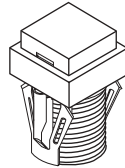

05 .551" Round

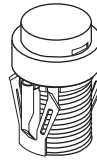

06 .551" x .728" Rectangular

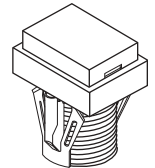

The bezel is an integral part of the indicator body.

Panel Cutouts

Bushing Mounting

Without Keyway

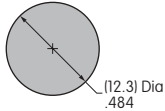

Panel Thickness
0.5 ~ 8.0mm
(.020 ~ .315")

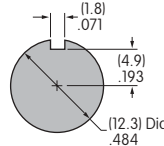

With Keyway

Snap-in Mounting

Panel Thickness
1.0 ~ 3.5mm
(.039 ~ .138")

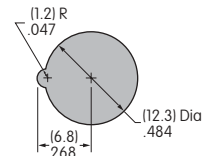

TERMINALS

W01 Silver Solder Lug

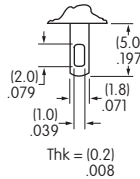

The .039" x .079" oblong hole accommodates one solid 20-gauge wire or two solid or stranded 22-gauge wires.

LAMP CODES & SPECIFICATIONS

Incandescent Lamp

AT611 T-1 Bi-pin		05	12	28 *	* Lamp life is significantly reduced in applications with DC current, high shock, vibration, and flashing or continuous illumination.	
	Voltage	V	5V AC	12V AC		28V AC
	Current	I	115mA	60mA		22mA
	Endurance	Hours	7,000 average			

Neon Lamp

AT615 T-1 Bi-pin		01	
	Voltage	V	110V AC
	Current	I	1.5mA
	Endurance	Hours	10,000 average
	Recommended Resistors:	33K ohms for 110V AC 100K ohms for 220V AC	



LAMP CODES & SPECIFICATIONS

Electrical specifications are determined at a basic temperature of 25°C. Lamp circuit is independent of switch operation.



For dimension drawings of lamps see the Accessories & Hardware Index (page Y1).

If the source voltage is greater than rated voltage, a ballast resistor is required. The ballast resistor calculation and more lamp detail are shown in the Supplement; see Supplement Index (page Z1).



Standard Single Element LED

AT614   T-1 Bi-pin	LEDs are colored in OFF state.	Color	C Red	D Amber	F Green
	Forward Peak Current	I_{FM}	50mA	50mA	50mA
	Continuous Forward Current	I_F	40mA	40mA	40mA
	Forward Voltage	V_F	1.75V	2.35V	2.35V
	Reverse Peak Voltage	V_{RM}	4V	4V	4V
	Current Reduction Rate Above 25°C	ΔI_F	0.67mA/°C	0.67mA/°C	0.67mA/°C

Bright Dual Element LED

AT628   T-1 1/4 Bi-pin	Color	5C Red	5D Amber	5F Green	
	Forward Peak Current	I_{FM}	40mA	40mA	40mA
	Continuous Forward Current	I_F	26mA	26mA	26mA
	Forward Voltage	V_F	1.9V	2.0V	2.2V
	Reverse Peak Voltage	V_{RM}	4V	4V	4V
	Current Reduction Rate Above 25°C	ΔI_F	0.50mA/°C	0.50mA/°C	0.50mA/°C

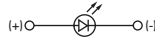
Super Bright Single Element LED

AT625G Blue AT631B White AT632F Green   T-1 Bi-pin		Color	6B White	6F Green	6G Blue	
		Forward Peak Current	I_{FM}	30mA	30mA	30mA
		Continuous Forward Current	I_F	20mA	20mA	20mA
		Forward Voltage	V_F	3.6V	3.5V	3.6V
		Reverse Peak Voltage	V_{RM}	5V	5V	5V
		Current Reduction Rate Above 25°C	ΔI_F	0.50mA/°C	0.50mA/°C	0.50mA/°C

CAP TYPES & COLOR COMBINATIONS

Color Codes: **B** White **C** Red **E** Yellow **F** Green **G** Blue **J** Clear

Solid Cap for Incandescent Lamp

Lens/Filter
Colors Available:

- | | |
|-----------|-----------|
| BB | FB |
| CB | FF |
| CC | GB |
| EB | GG |

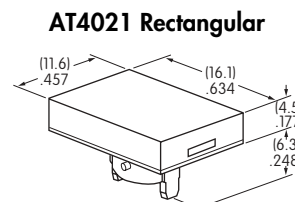
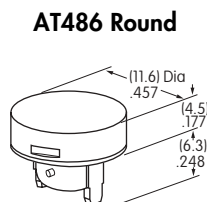
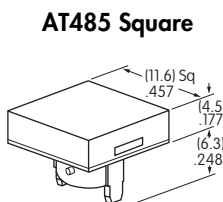

Material: Polycarbonate Finish: Glossy

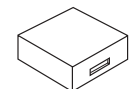

Translucent Colored Lens



Translucent Colored Filter



Lamp AT611

CAP TYPES & COLOR COMBINATIONS

Color Codes: A Black B White C Red D Amber E Yellow F Green G Blue J Clear

Insert Cap for Incandescent or Neon Lamp

Lens/Filter

Colors Available:

- JB**
- JC**
- JE**
- JF**
- JG**

AT487 Square

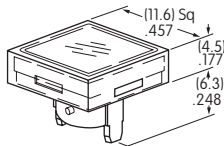

AT488 Round

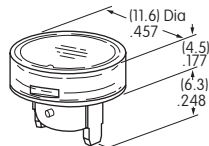

AT4022 Rectangular

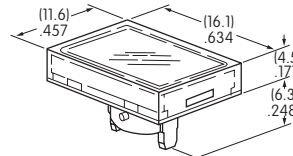

Material: Polycarbonate Finish: Glossy
JF & JG not suitable with neon.



Transparent Clear Lens



Translucent Colored Filter



Lamps AT611 or AT615

Cap for Standard & Bright LEDs

Cap/Window

Colors Available:

- AB**

Opaque Black Cap with
Translucent White Window
for Spot Illumination

**AT4051
Square**

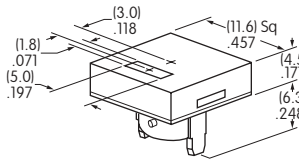

Material: Polycarbonate Finish: Matte

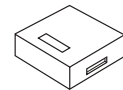

Standard LED
AT614



Bright LED
AT628

Lens/Diffuser

Colors Available:

- JC**
- JD**
- JF**

**AT489 for Standard
AT4158 for Bright
Square**

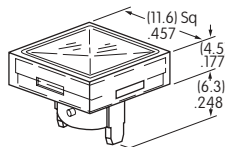

**AT490 for Standard
AT4160 for Bright
Round**

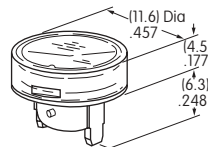

**AT4023 for Standard
AT4159 for Bright
Rectangular**

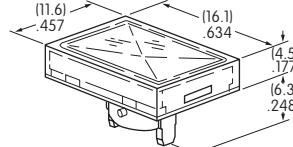

Material: Polycarbonate Finish: Glossy



Transparent Clear Lens



Translucent Colored Diffuser

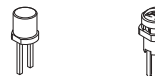

Standard LED
AT614

Bright LED
AT628

Cap for Bright & Super Bright LEDs

Lens/Diffuser

Colors Available:

- JB**

**AT4133
Square**

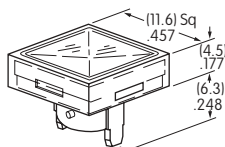

**AT4132
Round**

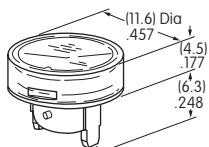

**AT4134
Rectangular**

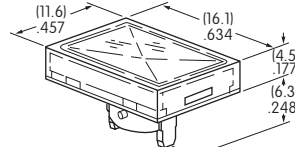

Material: Polycarbonate Finish: Glossy



Transparent Clear Lens



Translucent White Diffuser

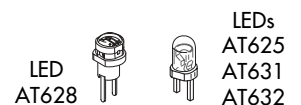

LED
AT628

LEDs
AT631
AT632

TYPICAL INDICATOR DIMENSIONS

Bushing Mounting

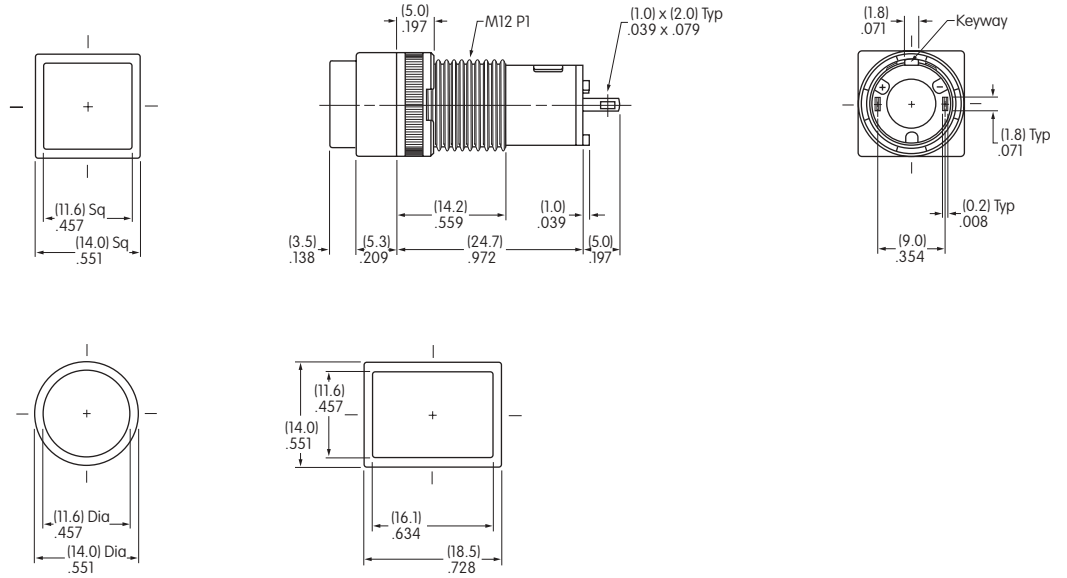

KB01KW01-05-GG

Snap-in Mounting

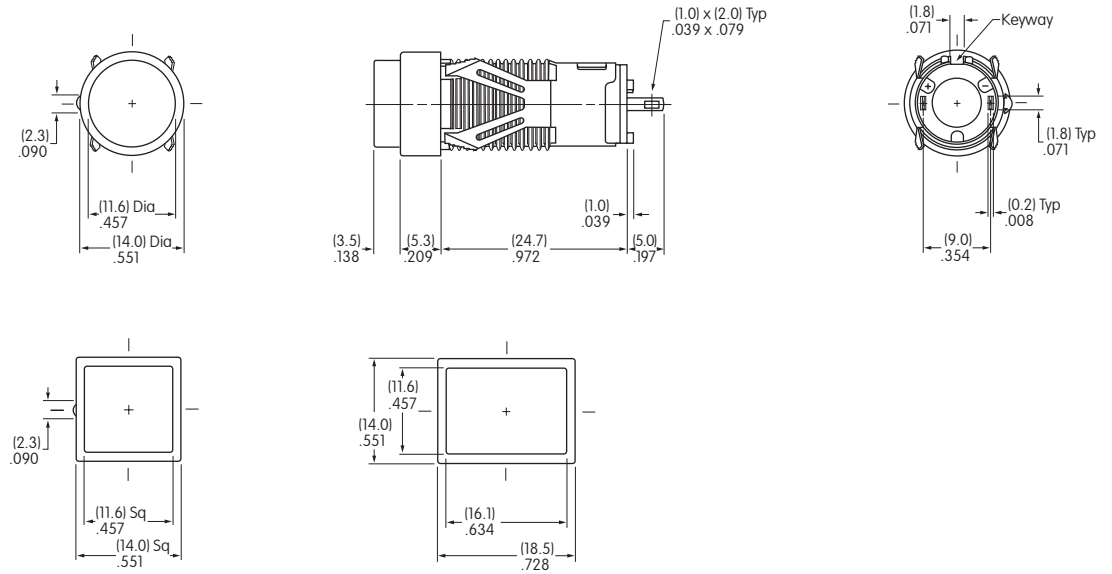

KB05KW01-05-FF