

TYPICAL SWITCH ORDERING EXAMPLE

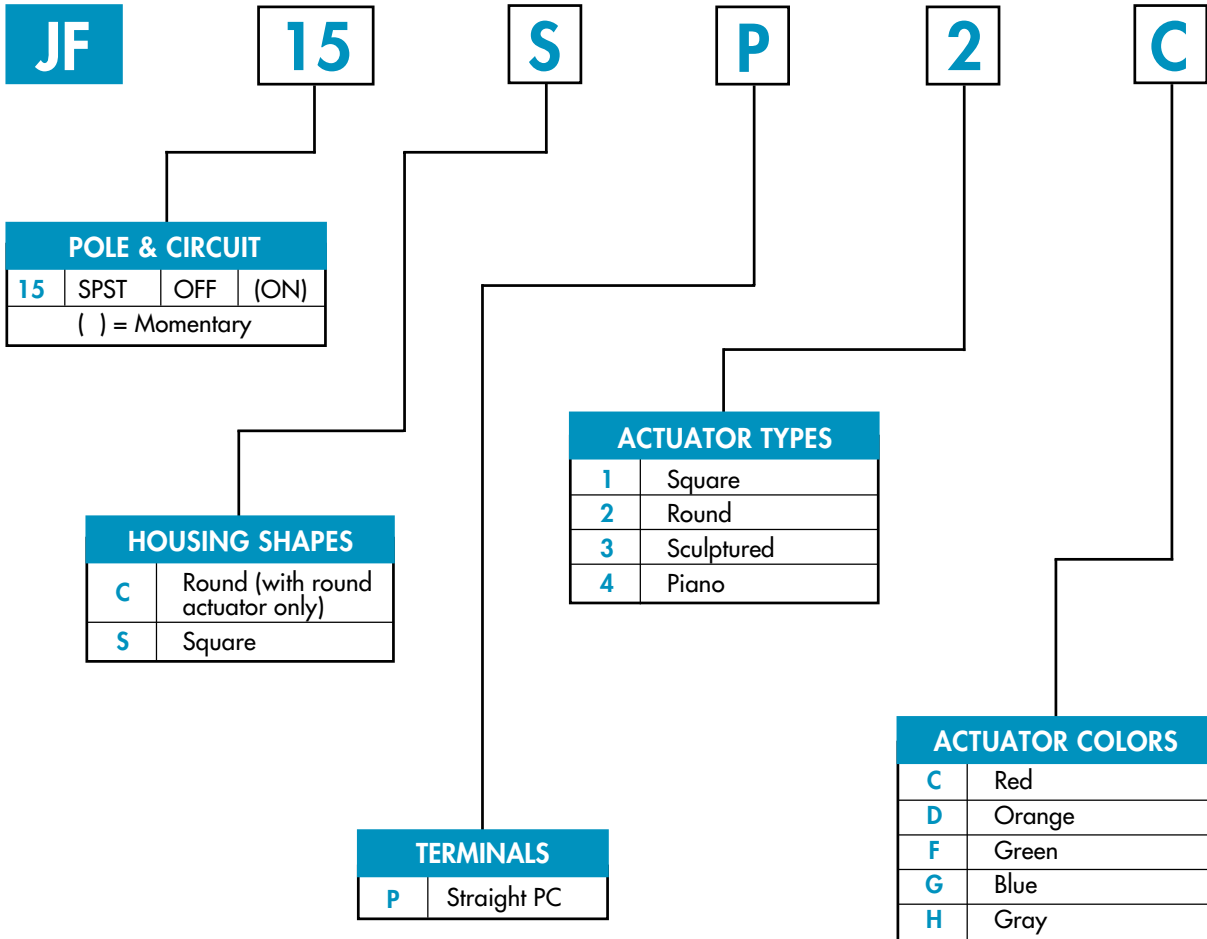

DESCRIPTION FOR TYPICAL ORDERING EXAMPLE

JF15SP2C



GENERAL SPECIFICATIONS

Electrical Capacity (Resistive Load)

Power Level: 50mA @ 24V DC

Other Ratings

Contact Resistance:	50 milliohms maximum
Insulation Resistance:	500 megohms minimum @ 250V DC
Dielectric Strength:	250V AC minimum
Mechanical Life:	500,000 operations minimum
Electrical Life:	500,000 operations minimum
Nominal Operating Force:	200 grams for sculptured actuator 204 grams for piano actuator 306 grams for square & round flush actuators
Contact Bounce:	0.1 millisecond maximum
Total Travel:	0.4mm (.016") for flush actuators; 0.8mm (.031") for sculptured & piano actuators

Materials & Finishes

Actuator:	Polyamide
Case:	Glass fiber reinforced polyamide
Seal:	Nitrile butadiene rubber
Base:	Glass fiber reinforced polyester
Movable Contact:	Phosphor bronze with silver plating
Stationary Contacts:	Brass with silver plating
Terminals:	Brass with silver plating

Environmental Data

Operating Temp Range:	-25°C through +85°C (-13°F through +185°F)
Humidity:	90 ~ 95% humidity for 96 hours @ 40°C (104°F)
Vibration:	10 ~ 55Hz with peak-to-peak amplitude of 1.5mm traversing the frequency range & returning in 1 minute; 3 right angled directions for 2 hours
Shock:	50g acceleration (tested in 6 right angled directions, with 5 shocks in each direction)

Installation

Soldering Time & Temperature:	3 seconds @ 350°C or 5 seconds @ 270°C
Process Seal:	See Supplement Index (page Z1) for specific processing data.

POLE & CIRCUIT

		Actuator Position () = Momentary		Switch Throw & Schematic		
Pole	Model	Normal	Down	SPST		Note: Terminal numbers are shown on switch.
SP	JF15	OFF	(ON)			

HOUSING SHAPES & ACTUATOR TYPES

C Round Housing		S Square Housing				
2 Round Actuator	1 Square Actuator	2 Round Actuator	3 Sculptured Actuator	4 Piano Actuator		
Cap Colors Available:	C Red	D Orange	F Green	G Blue	H Gray	Housing is black.

TERMINALS

P Straight PC

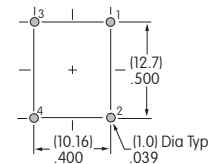
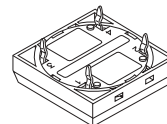

Further details shown in Typical Switch Dimensions.

TYPICAL SWITCH DIMENSIONS

Round Actuator

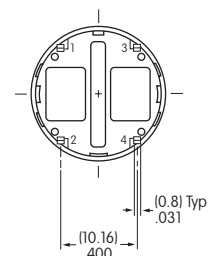
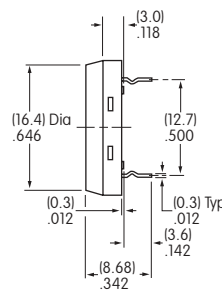
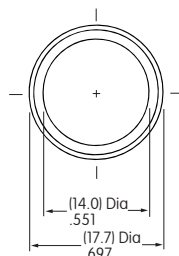

JF15CP2C

TYPICAL SWITCH DIMENSIONS

Square Actuator

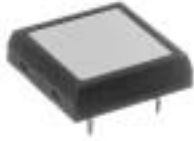

JF15SP1C

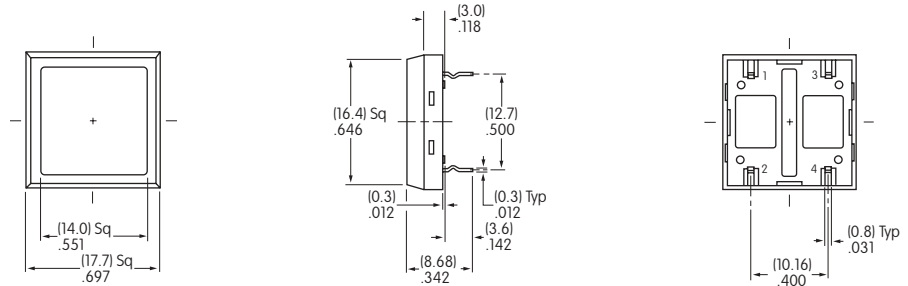

Round Actuator



JF15SP2C

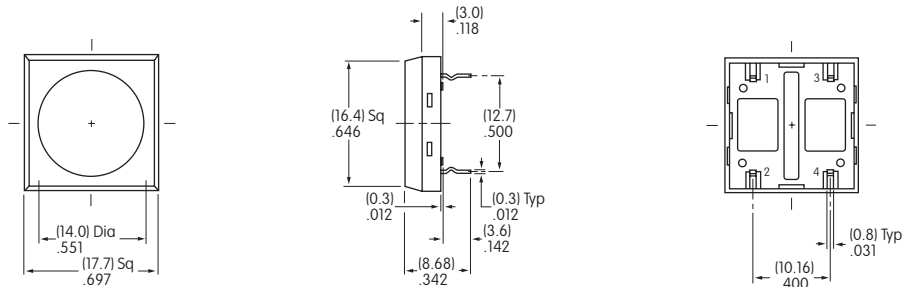

Sculptured Actuator



JF15SP3C

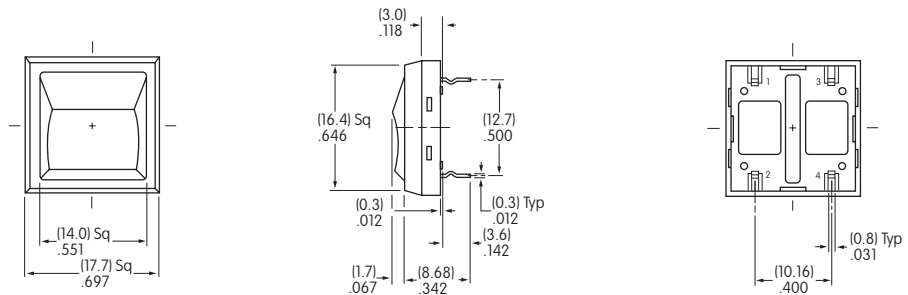

Piano Actuator



JF15SP4C

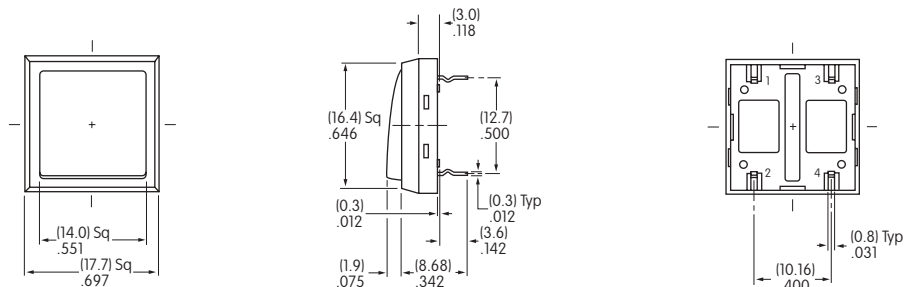

LEGENDS

General information and basic specifications are presented here for customers who want to do their own legends.

Suggested Printable Area

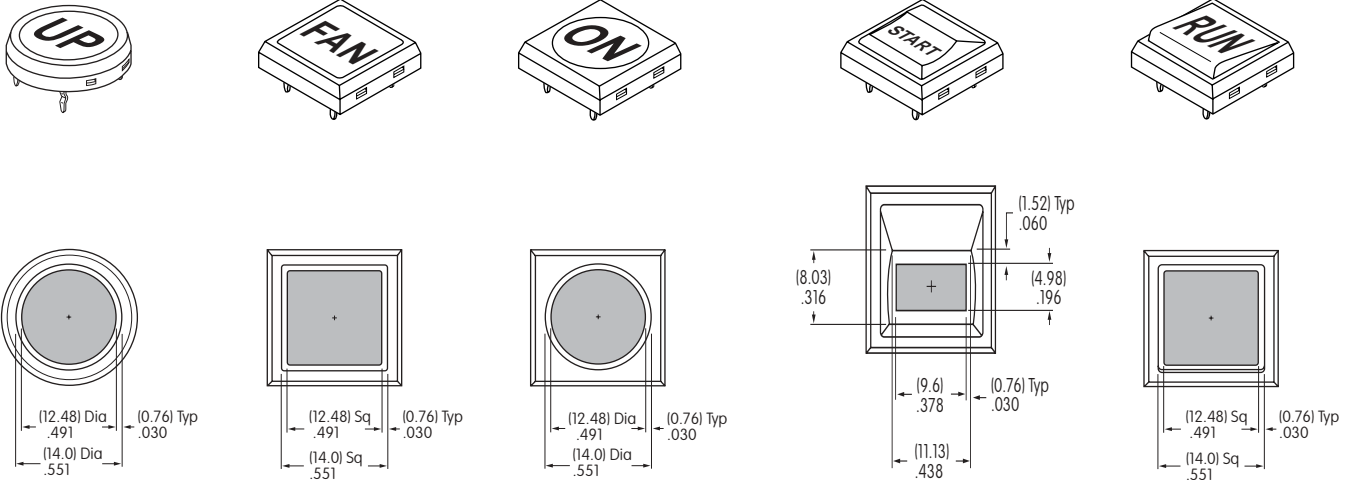

Recommended Print Method:

Screen Print or Pad Print

Shaded areas are printable areas.

Epoxy based ink is recommended.

Additional Method

Engraving is not recommended as an additional method for legends. Contact factory if engraving is required; it must be done before the actuator is assembled.

LEGEND PACKET FOR ORDERING SWITCHES WITH LEGENDS



1. To order switches with legends contact the factory and request the JF Nonilluminated Legend Packet.
2. Once you determine your desired legend, fill out the ordering work sheet included in the packet.
3. Return the completed work sheet to receive a quotation.