

TYPICAL SWITCH ORDERING EXAMPLE

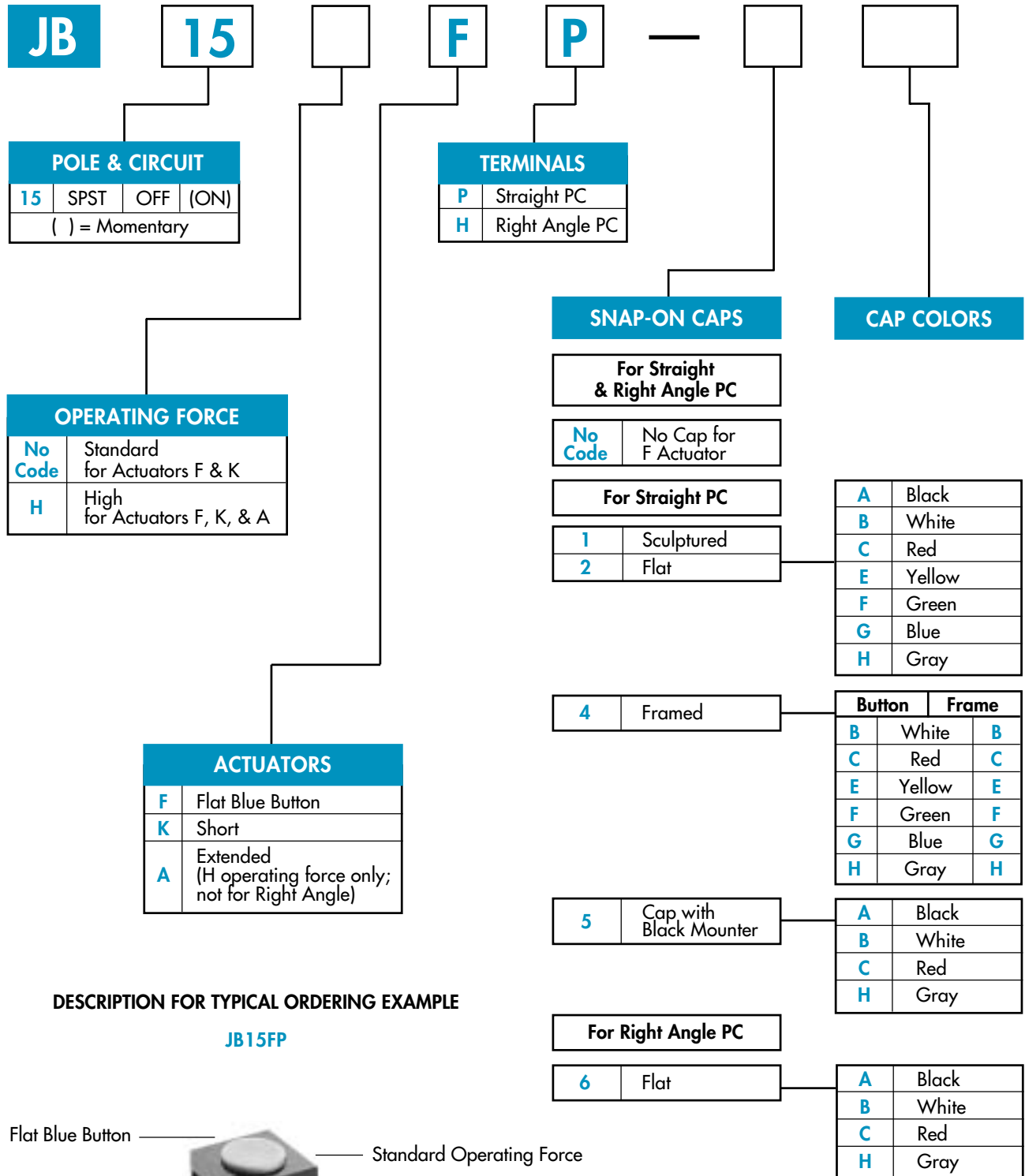

DESCRIPTION FOR TYPICAL ORDERING EXAMPLE

JB15FP

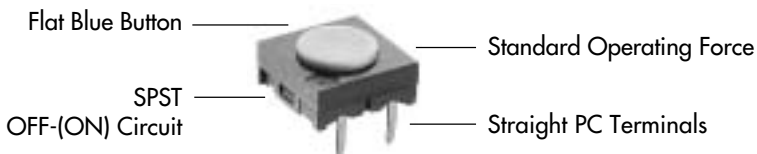

GENERAL SPECIFICATIONS

Electrical Capacity (Resistive Load)

Power Level: 50mA @ 24V DC maximum for Standard Operating Force models
125mA @ 24V DC maximum for High Operating Force models

Other Ratings

| | Standard Operating Force | High Operating Force |
|---------------------------------|---|---|
| Contact Resistance: | 50 milliohms maximum | 50 milliohms maximum |
| Insulation Resistance: | 500 megohms minimum @ 250V DC | 500 megohms minimum @ 250V DC |
| Dielectric Strength: | 250V AC minimum | 250V AC minimum |
| Mechanical Life: | 5,000,000 operations minimum | 1,000,000 operations minimum |
| Electrical Life: | 5,000,000 operations minimum | 1,000,000 operations minimum |
| Nominal Operating Force: | 180 grams (JB15) | 270 grams (JB15H) |
| Contact Bounce: | 0.1 millisecond maximum with normal hand operation | 0.1 millisecond maximum with normal hand operation |
| Total Travel: | .250mm (.010") | .300mm (.012") |

Materials & Finishes

| | |
|-----------------------------|--------------------------------------|
| Actuator: | Glass fiber reinforced polyester |
| Case: | Glass fiber reinforced polyamide |
| Seal: | Nitrile butadiene rubber |
| Base: | Glass fiber reinforced polyester |
| Movable Contacts: | Beryllium copper with silver plating |
| Stationary Contacts: | Brass with silver plating |
| Terminals: | Brass with silver plating |
| Mounting Bracket: | Phosphor bronze with tin plating |

Environmental Data

| | |
|------------------------------|--|
| Operating Temp Range: | -25°C through +70°C (-13°F through +158°F) |
| Humidity: | 90 ~ 95% humidity for 96 hours @ 40°C (104°F) |
| Vibration: | 10 ~ 55Hz with peak-to-peak amplitude of 1.5mm traversing the frequency range & returning in 1 minute; 3 right angled directions for 2 hours |
| Shock: | 50g acceleration (tested in 6 right angled directions, with 5 shocks in each direction) |

Installation

| | |
|--|--|
| Soldering Time & Temperature: | 3 seconds @ 350°C manual soldering or 5 seconds @ 270°C solder pot Automated soldering is highly recommended. |
| Process Seal: | See Supplement Index (page Z1) for specific processing data. |

POLE & CIRCUIT

| | | Actuator Position () = Momentary | | Switch Throw & Schematic | | |
|------|-------|--------------------------------------|------|--------------------------|--|---|
| Pole | Model | Normal | Down | SPST | | Note: Terminal numbers are shown on switch. |
| SP | JB15 | OFF | (ON) | | | |

OPERATING FORCE



Standard Nominal Operating Force
For F & K Actuators.

180 gf



High Nominal Operating Force
For F, K, &, A Actuators.

270 gf

ACTUATORS

F Flat Blue Button

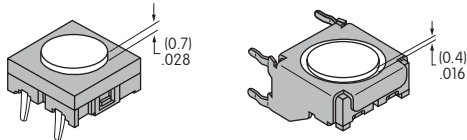

Flat button is an integral part of the switch and cannot be ordered separately.

K Short Actuator

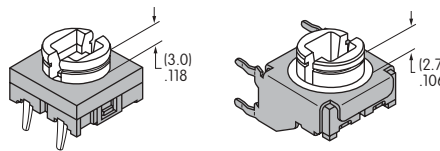

A Extended Actuator

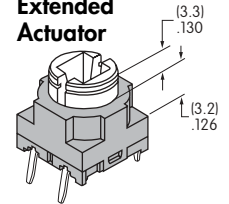

Combines with high operating force only; not for right angle.

TERMINALS

P Straight PC

Further details shown in Typical Switch Dimensions.

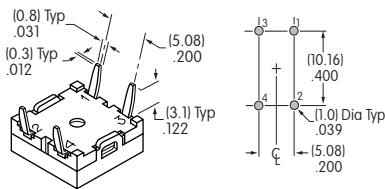

H Right Angle PC

Further details shown in Typical Switch Dimensions.

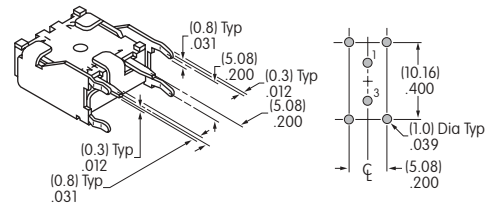

SNAP-ON CAPS

1 AT4058 Sculptured for Straight PC

Material: Polyamide
Finish: Matte
Colors: A B C E F G H

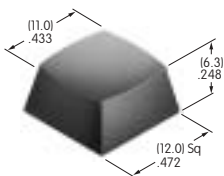

2 AT4059 Flat for Straight PC

Material: Polycarbonate
Finish: Glossy
Colors: A B C E F G H

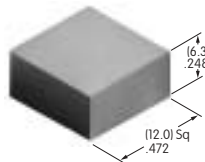

4 Framed: AT4077 Button & AT4078 Frame for Straight PC

Material: Polycarbonate
Finish: Matte
Colors: B C E F G H

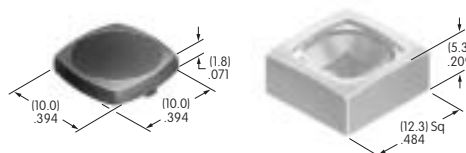

6 AT4139 Flat for Right Angle PC

Material: Polycarbonate
Finish: Glossy
Colors: A B C H

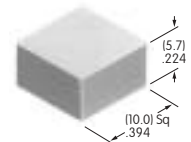

Cap Colors Available:



Black



White



Red



Yellow



Green



Blue



Gray

SNAP-ON CAPS (CONTINUED)

5 AT4140 Cap with AT547 Mounter for Straight PC

Cap
Material: Polycarbonate
Finish: Glossy
Colors: A B C H

Mounter
Material: Polyamide
Finish: Matte
Color: A

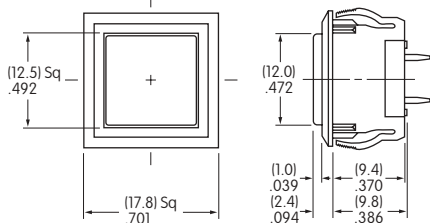

Panel Mounting Dimensions

Panel Thickness: 1.0mm ~ 2.0mm (.039" ~ .079")

Panel Cutout & Footprint:

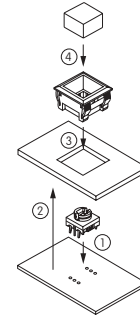
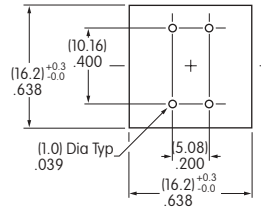

Assembly Procedure

1. Solder switch to PCB.
2. Install PCB in equipment.
3. Snap mounter into panel. Dimension from top of panel to top of PCB is 9.8mm (.386")
4. Snap cap onto plunger.

TYPICAL SWITCH DIMENSIONS

Spring action terminals conform to .100" PCB spacing.

Flat Blue Button • Straight PC



JB15FP

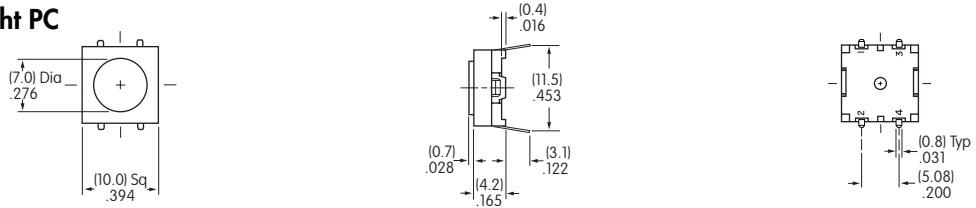

Sculptured Snap-on Cap



JB15KP-1C

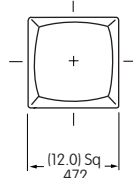

Short Actuator

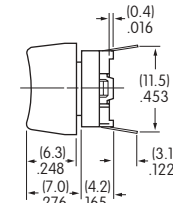

Extended Actuator

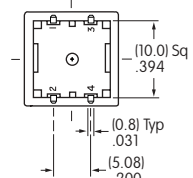
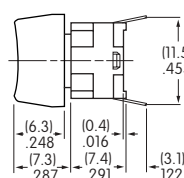

Flat Snap-on Cap • Straight PC



JB15KP-2C

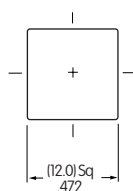

Short Actuator

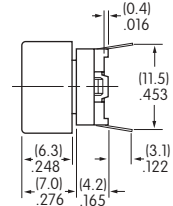

Extended Actuator

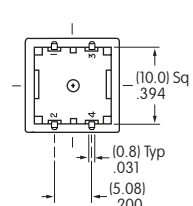
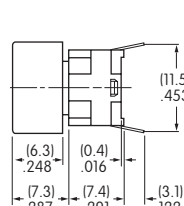

Framed Snap-on Cap • Straight PC



JB15HAP-4BC

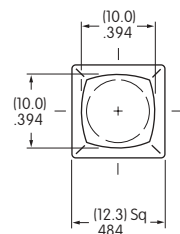

Short Actuator

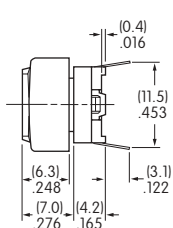

Extended Actuator

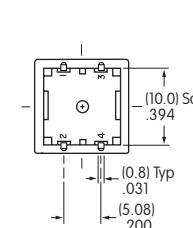
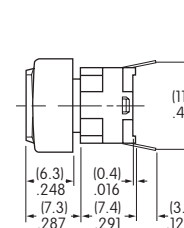

TYPICAL SWITCH DIMENSIONS

Spring action terminals conform to .100" PCB spacing.

Flat Blue Button • Right Angle PC



JB15FH

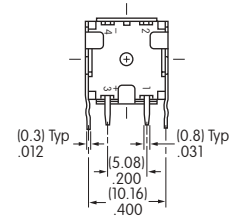
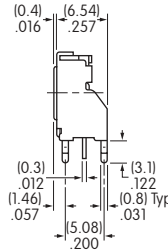
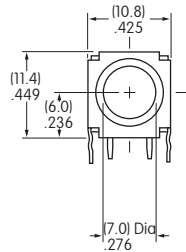

Flat Snap-on Cap • Right Angle PC



JB15KH-6C

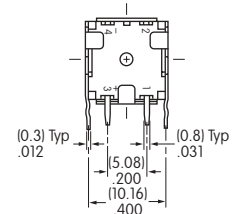
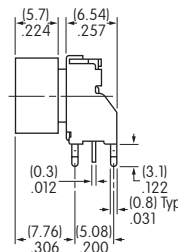
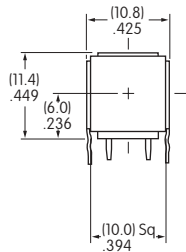

LEGENDS

General information and basic specifications are presented here for customers who want to do their own legends.

Suggested Printable Area for Caps

AT4058

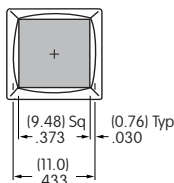

Recommended Print Method:

AT4059 & AT4140

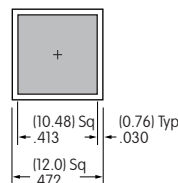
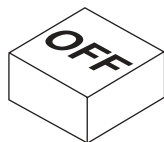

Screen Print or Pad Print

AT4077 Button

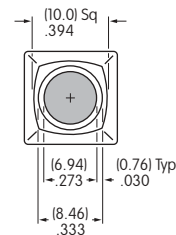

Epoxy based ink is recommended.

AT4139

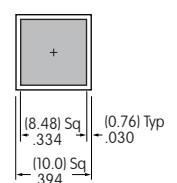
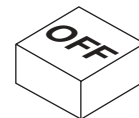

Shaded areas are printable areas.

Additional Method

An additional method for legends is engraving the cap. Maximum depth for engraving is 0.3 mm (.012") on the cap. Enamel paint is recommended to fill the engraved area.

LEGEND PACKET FOR ORDERING CAPS WITH LEGENDS

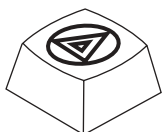

1. To order caps with legends contact the factory and request the JB Legend Packet.
2. Once you determine your desired legend, fill out the ordering work sheet included in the packet.
3. Return the completed work sheet to receive a quotation.