

TYPICAL INDICATOR ORDERING EXAMPLE

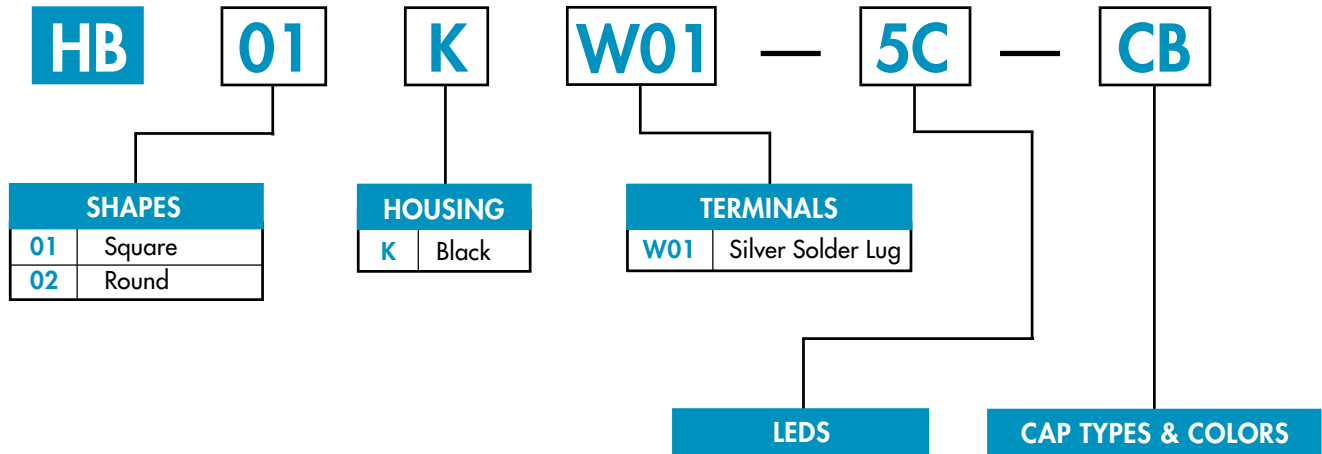

DESCRIPTION FOR TYPICAL ORDERING EXAMPLE

HB01KW01-5C-CB

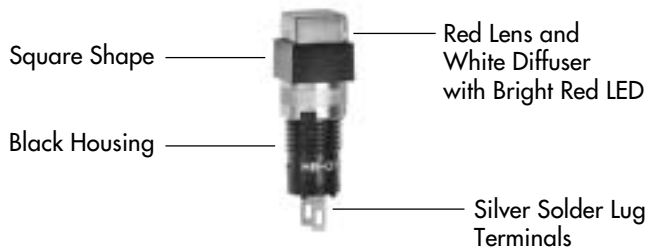

| Bright | |
|--------|-------|
| 5C | Red |
| 5D | Amber |
| 5F | Green |

| LED Cap: Lens/Diffuser Colors | |
|-------------------------------|-------------|
| CB | Red/White |
| DB | Amber/White |
| FB | Green/White |
| JB | Clear/White |

| Super Bright | |
|--------------|-------|
| 6B | White |
| 6F | Green |
| 6G | Blue |

| LED Cap: Lens/Diffuser Colors | |
|-------------------------------|-------------|
| JB | Clear/White |

LED COLORS & SPECIFICATIONS

| Bright AT633 | Attention Electrostatic Sensitive Devices | Color | Bright | | | Super Bright | | | Unit | |
|---|---|-----------------------------------|--------------|---------------|------|--------------|---------------|------|------|-------|
| | | | 5C | 5D | 5F | 6B | 6F | 6G | | |
| Super Bright AT624G Blue AT629B White AT630F Green | T-1 Bi-pin | Forward Peak Current | I_{FM} | 30 | 30 | 25 | 30 | 30 | 30 | mA |
| | | Continuous Forward Current | I_F | 20 | 20 | 20 | 20 | 20 | 20 | mA |
| | | Forward Voltage | V_F | 1.85 | 2.0 | 2.2 | 3.6 | 3.5 | 3.6 | V |
| | | Reverse Peak Voltage | V_{RM} | 5 | 5 | 5 | 5 | 5 | 5 | V |
| | | Current Reduction Rate Above 25°C | ΔI_F | 0.40 | 0.42 | 0.38 | 0.50 | 0.50 | 0.50 | mA/°C |
| | | Ambient Temp Range | | -25°C ~ +50°C | | | -25°C ~ +50°C | | | |

Electrical specifications are determined at a basic temperature of 25°C. LED circuit is independent of switch operation. Single element LED is colored in OFF state. For dimension drawings see the Accessories & Hardware Index (page Y1).

If the source voltage is greater than rated voltage, a ballast resistor is required.

The ballast resistor calculation and more lamp detail are shown in the Supplement; see Supplement Index (page Z1).

CAP TYPES & COLOR COMBINATIONS

Colored Cap for Bright LED

Lens/Diffuser
Colors Available:

- CB** Red/White
- DB** Amber/White
- FB** Green/White

Material: Polycarbonate
Finish: Glossy

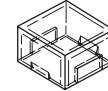
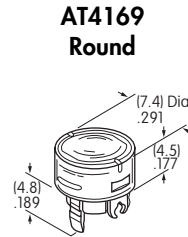
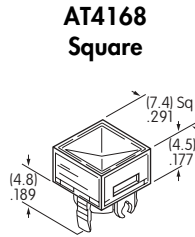

Transparent Colored Lens



Translucent White Diffuser



Colored LED AT633

White Cap for Bright & Super Bright LED

JB Clear Lens/
White Diffuser

Material: Polycarbonate
Finish: Glossy

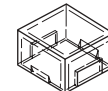
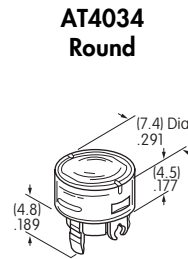
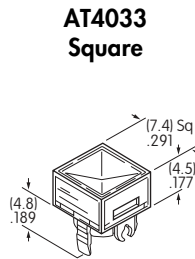

Transparent Clear Lens



Translucent White Diffuser



LEDs
AT624, AT629,
AT630, AT633

TYPICAL INDICATOR DIMENSIONS

Square

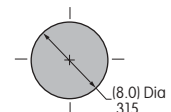
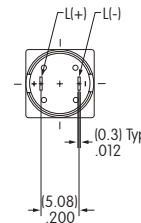
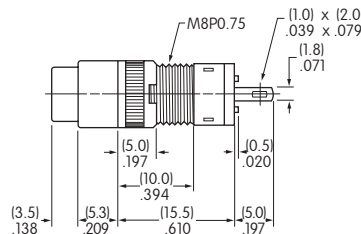
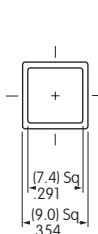

Recommended Panel
Thickness: 0.5 ~ 5mm
(.020" ~ .197")

HB01KW01-5C-CB

The 1mm x 2mm oblong terminal hole accommodates one solid or stranded 20-gauge wire or two 22-gauge wires.

Round

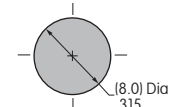
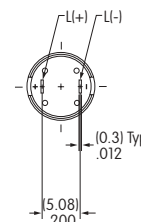
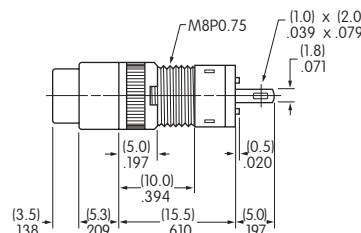
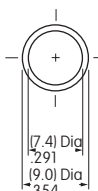

Recommended Panel
Thickness: 0.5 ~ 5mm
(.020" ~ .197")

HB02KW01-5C-CB

The 1mm x 2mm oblong terminal hole accommodates one solid or stranded 20-gauge wire or two 22-gauge wires.