

Coded Switches Type C07 (Concentric)

- 16 position coded output
one pole 3 pos. center off
- >10'000 switching cycles
16 pos.
>7'500 switching cycles
3 pos.
- small and rugged
- tape & reel
- leadfree reflowable
- steel spindle-shaft
- IP 64 (inner shaft)

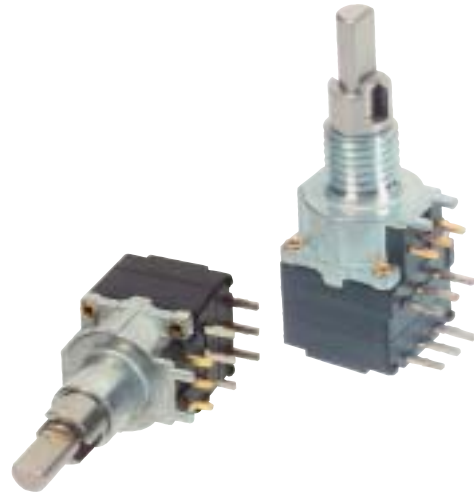

Horizontal

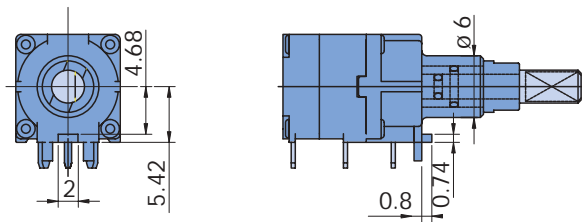

Front panel cut out

Drilling diagram
view from component side

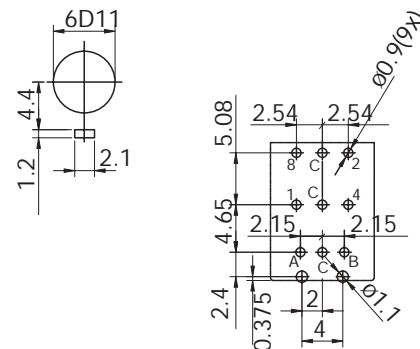

Horizontal for panel mounting

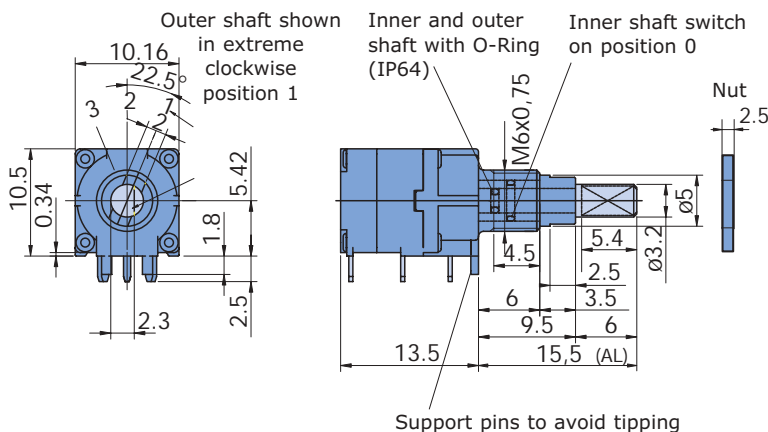

Front panel cut out

Horizontal

Coding	Switching function	Positions (with end stop)	Indexing angle	Tape & Reel (250pcs)	Packaging (50pcs)
HEX	shorting	16	22,5°	C07-1153T	C07-1153
one pole 3 pos. center off	shorting	3	22,5°		
Gray Code	shorting	16	22,5°	C07-1173T	C07-1173
one pole 3 pos. center off	shorting	3	22,5°		

Horizontal for panel mounting

Coding	Switching function	Positions (with end stop)	Indexing angle	Tape & Reel (250pcs)	Packaging (50pcs)
HEX	shorting	16	22,5°	C07-1153T200000	C07-1153-200000
one pole 3 pos. center off	shorting	3	22,5°		
Gray Code	shorting	16	22,5°	C07-1173T200000	C07-1173-200000
one pole 3 pos. center off	shorting	3	22,5°		

O-Ring and nut supplied

Tape & Reel Packaging

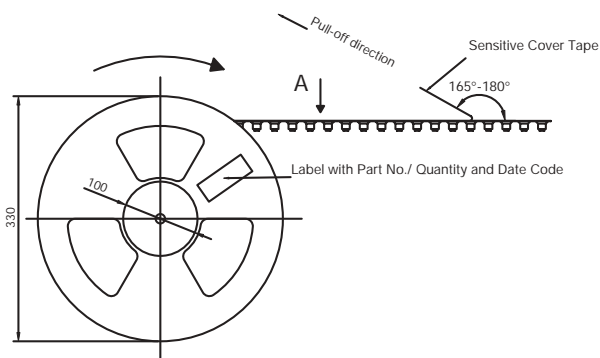

View A

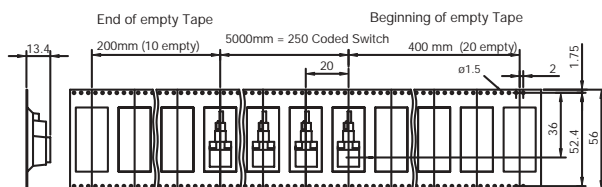

Part conforms to EIA-481-B standards

Coding

Outer Shaft

	A	B
1	●	
2		
3		●

Inner Shaft Hexidecimal

	8	4	2	1
0				
1				●
2			●	
3			●	●
4	●			
5	●			●
6	●	●		
7	●	●	●	
8	●			
9	●			●
A	●		●	
B	●	●	●	
C	●	●		
D	●	●		●
E	●	●		
F	●	●	●	

Inner Shaft Gray Code

	8	4	2	1
0				
1				●
2			●	●
3			●	
4	●	●		
5	●	●	●	
6	●		●	
7	●			
8	●	●		
9	●	●		●
A	●	●	●	●
B	●	●	●	
C	●		●	
D	●		●	●
E	●			●
F	●			

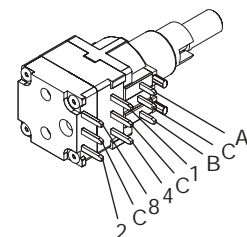

1 mm = 0.04 inch, 1 inch = 25.4 mm

Items available from stock!