



Multi-Function Tact Switches for SMT

Specification:

Contact rating:	5 V DC, 10 mA
Contact resistance:	< 500 mΩ max.
Insulation resistance:	> 100 MΩ
Dielectric strength:	100 V, 50 Hz for the duration of 1 minute
Operating temperature:	- 20° to + 60° C
Mechanical life:	minimum 100 000 cycles
Contacts:	phosphor bronze silver-plated
Mounting:	on pc-board – SMD
Soldering conditions:	reflow-soldering – max.: 240° C +/- 5° C, 10 sec max.

3

Models:

PLSJ 1

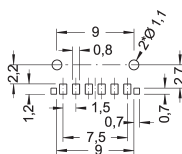
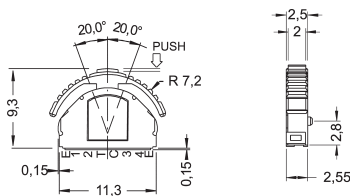

Terminal \ Angle	20°	16°	8°	0°	8°	16°	20°
1	█	█	█				
2	█	█					
3							
4						█	█
C	█	█	█	█	█	█	█

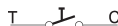

Packing unit: 1000 pieces per reel