



Subminiature Toggle Switches

Specifications:

| | |
|------------------------|--|
| Contact rating: | max. 20 V AC / DC, 0,4 VA |
| Contact resistance: | < 20 mΩ |
| Insulation resistance: | > 1000 MΩ |
| Dielectric strength: | 1000 V, 50 Hz for the duration of 1 minute |
| Operating temperature: | - 30° to + 85° C |
| Mechanical life: | minimum 50 000 operations |
| Contacts/Terminals: | copper alloy, gold-plated over nickel |
| Material: | case: nylon with glass fibre, meets UL 94 V-0, washable support: brass, tin-plated lever: brass, chromium-plated |
| Mounting: | on pc-board |

2

Models: Switching functions: the closed contacts are opposite to the lever position.

washable

SPDT

TST 1 D
TST 1 E
TST 1 F

on - on
on off on
on - mom

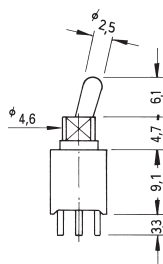
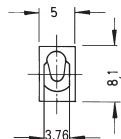
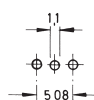

SPDT

TST 1 D - RA
TST 1 E - RA
TST 1 F - RA

on - on
on off on
on - mom

